

GEBERIT SYSTEM ACCESSORIES

Optional Waste Fittings

SPECIFICATIONS

Installation accessories for Geberit Duofix concealed carriers. Accessories shall be for alternate waste fitting installations, including cast iron elbows, back-to-back, and horizontal runs.

FEATURES

Installation accessories for:

- Straight back
- Left hand or right hand runs
- Cast iron 90
- Back to back vertical or left hand/right hand runs

WARRANTY

- One-year limited warranty against manufacturers' defect.

Waste Fitting Discharge Configurations for Floor Mount Back Outlet Toilets

Note: Mounting collar/clamp by installer

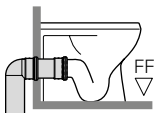



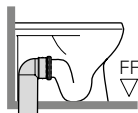

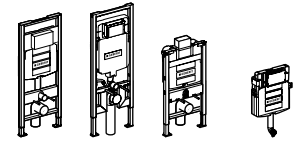

A. Floor-Mount Rear Discharge into Wall

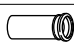

B. Floor-Mount Rear Discharge into Floor

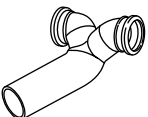
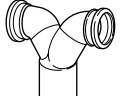

Description	Model Number	111.335	111.798	111.012	109.304
 PP connector set with bend for floor-mount toilets with mounting hardware, 1 x 90° bends with socket for Ø4.375" (Ø110 mm) push fit piping for Ø3.82"–4.21" (Ø97–107 mm) male connection and expansion to Ø4.375" (Ø110 mm) outlet	152.647.00.1				✓ (For A or B discharge. See illustration)
 HDPE waste fitting outlet bend, 1 x 90° bend with socket for Ø3.50" (Ø90 mm) push fit piping and Ø3.50" (Ø90 mm) outlet	366.061.16.1				✓ (For A discharge. See illustration)
 HDPE straight connector with socket for Ø3.50" (Ø90 mm) push fit piping and Ø3.50" (Ø90 mm) outlet x 12" (31 cm) long	366.887.16.1	✓	✓	✓	✓ (For A discharge. See illustration)
 HDPE connector with offset for LH horizontal drain connections (as viewed from sitting position), 1 x 90° bend with socket for Ø3.50" (Ø90 mm) push fit piping, with 45° offset and Ø3.50" (Ø90 mm) outlet for 5.5" (13.97 cm) minimum walls only.	366.913.16.1	✓	✓	✓	✓ (For A discharge. See illustration)
 HDPE connector with offset for RH horizontal drain connections (as viewed from sitting position), 1 x 90° bend with socket for Ø3.50" (Ø90 mm) push fit piping, with 45° offset and Ø3.50" (Ø90 mm) outlet for 5.5" (13.97 cm) minimum walls only.	366.914.16.1	✓	✓	✓	✓ (For A discharge. See illustration)
 Cast iron fitting; 90° 3.5" (90mm) inlet, 3" outlet, 2" NPTF heel outlet NEW! May 2018	367.072.18.1	✓	✓	✓	✓ (For A discharge. See illustration)
 HDPE "Back-to-back" connector for horizontal drain connections; 2 x 90° bends with sockets for Ø3.50" (Ø90 mm) push fit piping, with 45° offset and expansion to Ø4.375" (Ø110 mm) outlet for 10.75" (27.31 cm) minimum walls only.	367.485.16.1	✓	✓	✓	✓ (For A or B discharge. See illustration)
 HDPE "Back-to-back" connector for vertical drain connections; 2 x 90° bends with sockets for Ø3.50" (Ø90 mm) push fit piping and expansion to Ø4.375" (Ø110 mm) outlet for 10.75" (27.31 cm) minimum walls only.	367.923.16.1	✓	✓	✓	✓ (For A or B discharge. See illustration)

Note: Any of these fittings in combination with Geberit Duofix carriers are cUPC and IPC listed.



ARCHITECT/ENGINEER APPROVAL	Variations Specified:
Job Name:	_____
_____	_____
Date:	Customer/Wholesaler:
Quantity:	_____
Model Specified:	Contractor:
_____	Architect:
_____	_____

GEBERIT SYSTEM ACCESSORIES

Optional Waste Fittings

DIMENSIONS

Model Number	Pipe Material	d	d1	A	D	H	K (Max. cut length)	L	a	I
152.647.00.1	PP	ø4" nom (110 mm)	ø4"± 3/16" (102 ± 5 mm)	3 1/2" (9 cm)	—	9" (23 cm)	—	13 3/4" (35 cm)	—	—
366.061.16.1	HDPE	ø3" nom. (90 mm)	ø3" nom. (90 mm)	4 3/8" (11 cm)	ø4 3/8" (11.2 cm)	8 7/8" (22.5 cm)	5 1/8" (13 cm)	—	—	—
366.887.16.1	HDPE	ø3" nom. (90 mm)	ø3" nom. (90 mm)	—	ø4 3/8" (11.2 cm)	—	9 7/16" (24 cm)	12 1/4" (31 cm)	—	10 7/8" (27.5 cm)
366.913.16.1	HDPE	ø3" nom. (90 mm)	ø3" nom. (90 mm)	3" (7.5 cm)	ø4 3/8" (11.2 cm)	4" (10 cm)	6" (15 cm)	11 3/8" (29 cm)	1 3/4" (4.5 cm)	—
366.914.16.1	HDPE	ø3" nom. (90 mm)	ø3" nom. (90 mm)	3" (7.5 cm)	ø4 3/8" (11.2 cm)	4" (10 cm)	6" (15 cm)	11 3/8" (29 cm)	1 3/4" (4.5 cm)	—
367.072.18.1	Cast Iron	3" nom. (84 mm)	3" nom. (90 mm)	4 3/8" (11 cm)	ø4 3/8" (11.2 cm)	5 7/8" (15 cm)	1 1/2" (3.5 cm)	—	—	—
367.923.16.1	HDPE	4" nom (110mm)	3" nom. (90 mm)	10 7/8" (27.5 cm)	ø4 3/8" (11.2 cm)	12 3/4" (32.5 cm)	7 1/2" (19 cm)	—	4 1/8" (10.5 cm)	—
367.485.16.1	HDPE	4" nom (110mm)	3" nom. (90 mm)	10 7/8" (27.5 cm)	ø4 3/8" (11.2 cm)	4" (10 cm)	4 3/4" (12 cm)	13 3/8" (34 cm)	4 1/8" (10.5 cm)	—

152.647.00.1

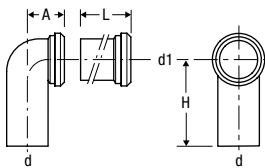

366.887.16.1

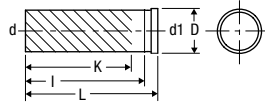

367.072.18.1

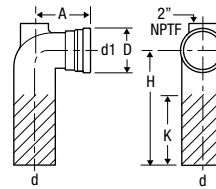

376.923.16.1

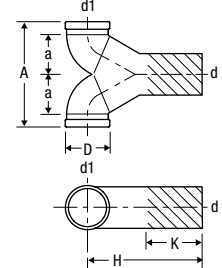

366.061.16.1
367.071.18.1

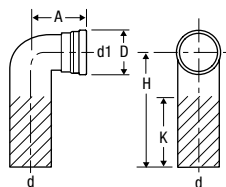

366.913.16.1

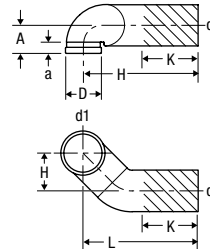

367.485.16.1

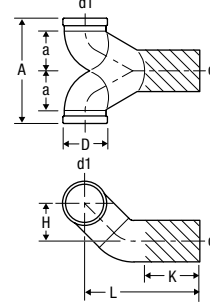

366.914.16.1

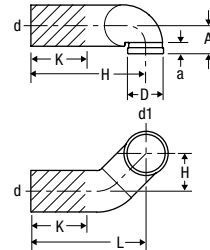

Geberit
2100 S. Clearwater Drive
Des Plaines, IL 60018
USA

P 847-803-7777
F 847-849-1845

www.geberit.us