

Replacement Parts for Mambo, Rumba, Tango, Sigma10 and Sigma30 Actuators

115.893 115.760 115.750 115.751 115.758 115.758
115.787

Actuator Dimensions: All Sigma and Tango models 9.7" x 6.5" (24.6 cm x 16.4 cm)



| Item | 1 | 2 | 3 | 4 | 5 | 6 | Model No. | Description | List Price |
|------|-----|-----|-----|-----|-----|-----|--------------|---|------------|
| 1 | 1 | 1 | 1 | 1 | 1 | 1 | 241.875.00.1 | Actuator bolt and rod kit | \$12.00 |
| 2 | 2 | 2 | 2 | 2 | 2 | 2 | 240.938.00.1 | Extension set for actuator plates for Sigma Concealed Tanks 2x6, 2x4, Kappa and Omega Concealed Tanks | 22.00 |
| 3 | 3 | 3 | 3 | | | 3 | 813.514.00.1 | Spring for actuator plate | 2.00 |
| 4 | 4 | 4 | 4 | 4 | 4 | 4 | 241.873.00.1 | Conversion kit for tool-free assembly (converts units manufactured prior to 04.01.2008) | 27.00 |
| 4.1 | 4.1 | 4.1 | 4.1 | 4.1 | 4.1 | 4.1 | 241.874.00.1 | Actuator bolt and rod kit, tool-free assembly | 11.00 |
| 4.2 | 4.2 | 4.2 | 4.2 | 4.2 | 4.2 | 4.2 | 241.876.00.1 | Mounting frame, tool-free assembly | 15.00 |
| | | | 4.3 | | | | 241.878.00.1 | Rocker mounting Mambo, tool free. From 2008 | 11.00 |
| 5 | 5 | | 5 | | | | 241.093.00.1 | Fastening for cover plate UP300 set-2 | 16.00 |
| 6 | 6 | | 6 | | | | 241.877.00.1 | Fastening set for mounting frame, tool-free assembly | 49.00 |

115.760, 115.750, 115.751, 115.758, 115.787, 115.893

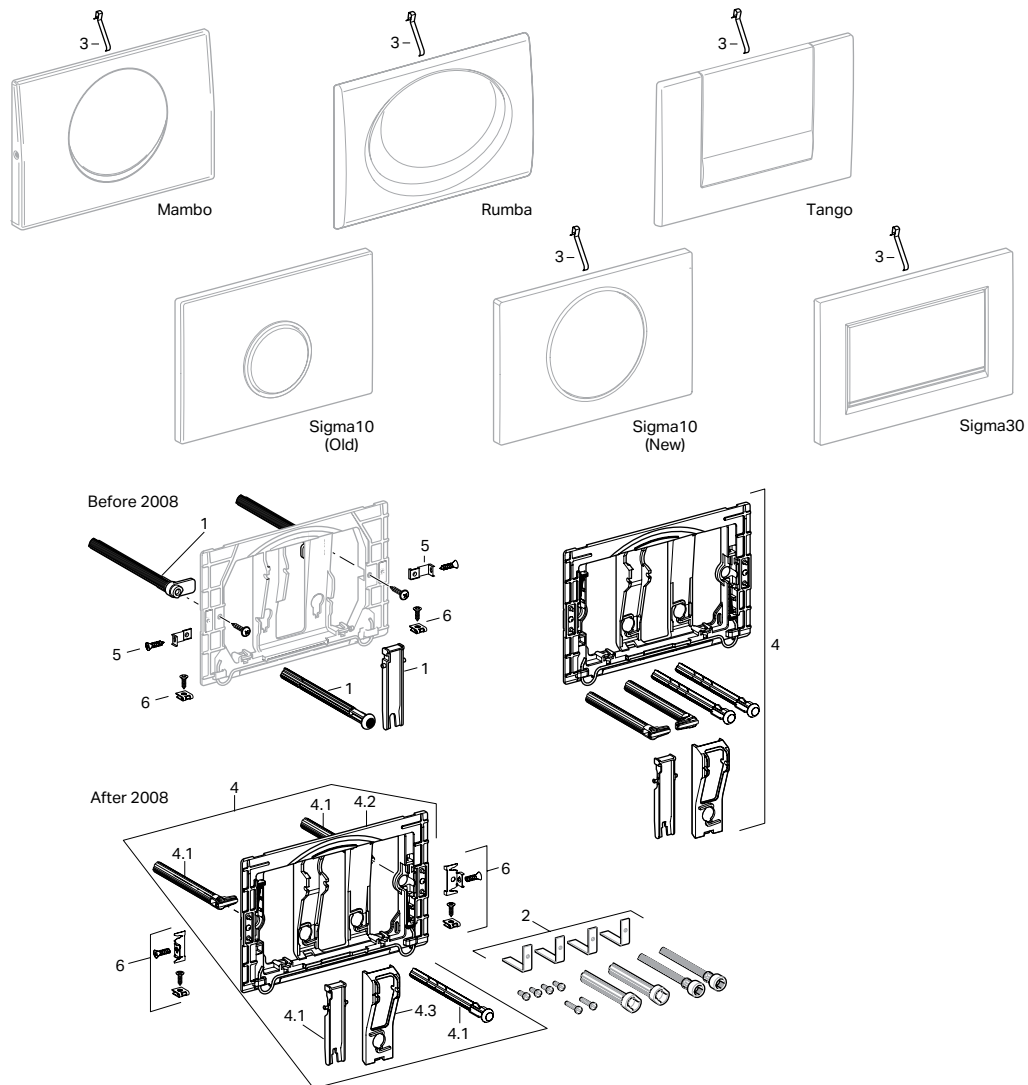

Products marked with  comply with the American Disabilities Act (ADA) when installed per the requirements of the latest ADA Accessibility Guidelines (ADAAG) and/or ICC/ANSI A117.1.