

GEBERIT INSTALLATION SYSTEMS

Replacement Parts

Geberit Hands-Free Type 10 and Mambo Urinal Actuator

116.035 116.025 116.033 116.023 116.036 116.026 116.028 116.038 Actuator Dimensions: 5.12" x 5.12" (13 cm x 13 cm)

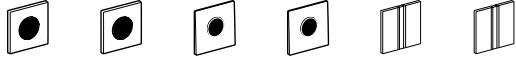

Item	1	1.1	2	3	4.1	4.2	4.3	5	6	6.1	7	8	8.1	8.3	9	10	11	11.1	12	Model No.	Description	List Price \$
1	1	1	1	1	1	1	1	1	1	1	1	1	1	1	1	1	1	1	1	241.934.00.1	Stop valve with throttle, complete	88.00
1.1	1.1	1.1	1.1	1.1	1.1	1.1	1.1	1.1	1.1	1.1	1.1	1.1	1.1	1.1	1.1	1.1	1.1	1.1	1.1	241.933.00.1	Regulating screw	30.00
2	2	2	2	2	2	2	2	2	2	2	2	2	2	2	2	2	2	2	2	241.931.00.1	Distance bolts, set	5.00
3	3	3	3	3	3	3	3	3	3	3	3	3	3	3	3	3	3	3	3	241.941.00.1	Sensor electronics	347.00
4.1		4.1		4.1		4.1		4.1		4.1		4.1		4.1		4.1		4.1		241.945.00.1	Battery housing for UR-control	20.00
	4.2		4.2		4.2		4.2		4.2		4.2		4.2		4.2		4.2		4.2	241.944.00.1	Transformer for UR-control	77.00
4.3		4.3																		—	2x "AA" alkaline batteries	—
5	5	5	5	5	5	5	5	5	5	5	5	5	5	5	5	5	5	5	5	241.943.00.1	Mounting frame for horizontal fixation	23.00
6	6	6	6	6	6	6	6	6	6	6	6	6	6	6	6	6	6	6	6	241.925.SN.1	Cover plate for UR-control Sigma10	208.00
6.1	6.1		6.1		6.1		6.1		6.1		6.1		6.1		6.1		6.1		6.1	241.905.00.1	IR window UR-control Sigma10	23.00
		6.2		6.2		6.2		6.2		6.2		6.2		6.2		6.2		6.2		241.903.00.1	Mambo only	27.00
7	7	7	7	7	7	7	7	7	7	7	7	7	7	7	7	7	7	7	7	241.947.00.1	Insulation protection with connection terminal	6.00
8	8	8	8	8	8	8	8	8	8	8	8	8	8	8	8	8	8	8	8	241.946.00.1	Solenoid valve for UR-control	158.00
8.1	8.1	8.1	8.1	8.1	8.1	8.1	8.1	8.1	8.1	8.1	8.1	8.1	8.1	8.1	8.1	8.1	8.1	8.1	8.1	241.932.00.1	Basket filter	5.00
8.3	8.3	8.3	8.3	8.3	8.3	8.3	8.3	8.3	8.3	8.3	8.3	8.3	8.3	8.3	8.3	8.3	8.3	8.3	8.3	243.327.00.1	Flushing Volume Control 4 GPM (14 LPM)	15.00
9	9	9	9	9	9	9	9	9	9	9	9	9	9	9	9	9	9	9	9	242.484.00.1	Flow limiter for UR-controls	9.00
10	10	10	10	10	10	10	10	10	10	10	10	10	10	10	10	10	10	10	10	242.156.00.1	Lip seal flushing pipe	5.00
																				241.926.GH.1	Geberit cover plate Type 50: Chrome-Brushed	208.00
																				241.926.QB.1	Geberit cover plate Type 50: Red Gold-Brushed	549.00
																				241.926.QD.1	Geberit cover plate Type 50: Black Chrome-Brushed	549.00
																				241.926.QF.1	Geberit cover plate Type 50: Brass-Brushed	549.00
																				241.906.00.1	IR window UR-control Type 50	31.00
																				243.579.00.1	Flushing Volume Control 2.4 GPM (4.5 LPM)	15.00

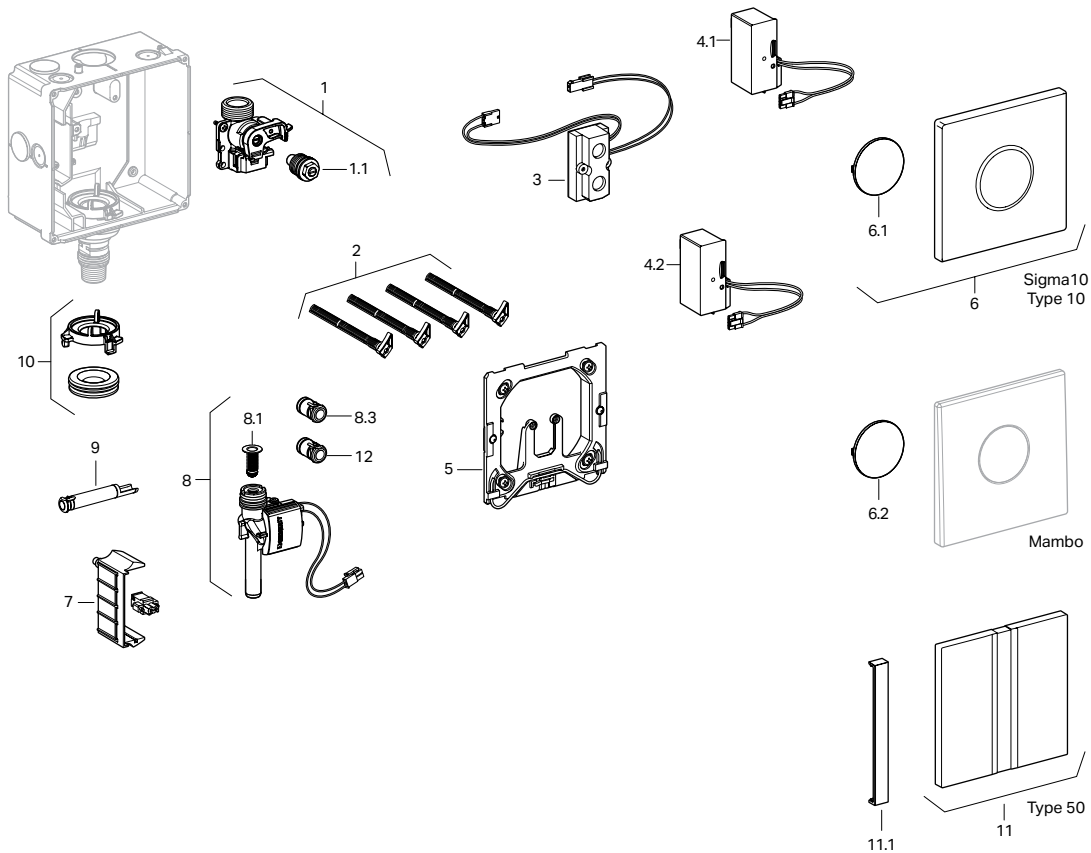

Products marked with  comply with the American Disabilities Act (ADA) when installed per the requirements of the latest ADA Accessibility Guidelines (ADAAG) and/or ICC/ANSI A117.1.

The information contained in this document is subject to change without notice.